

PART-01

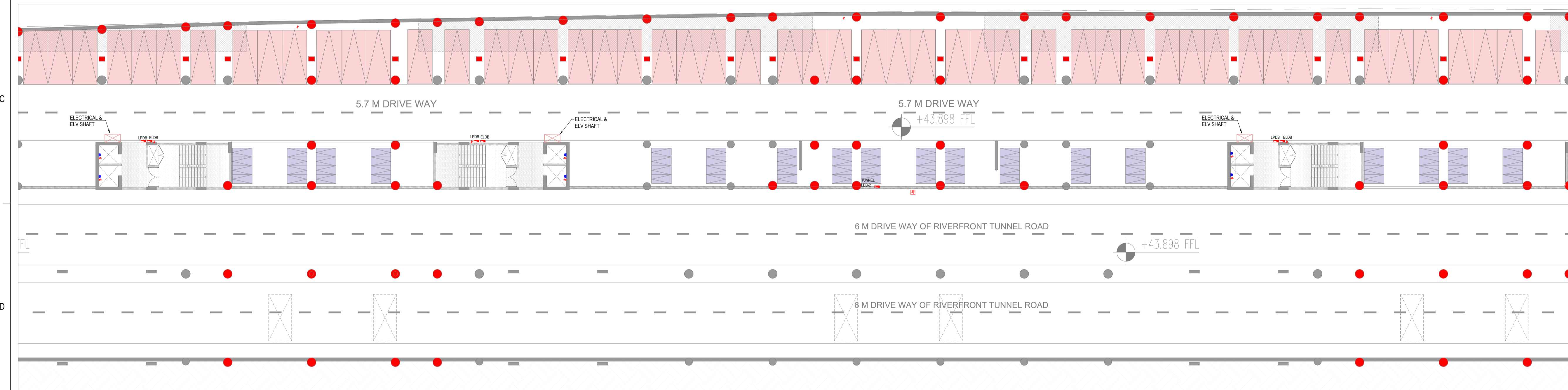

PART-02

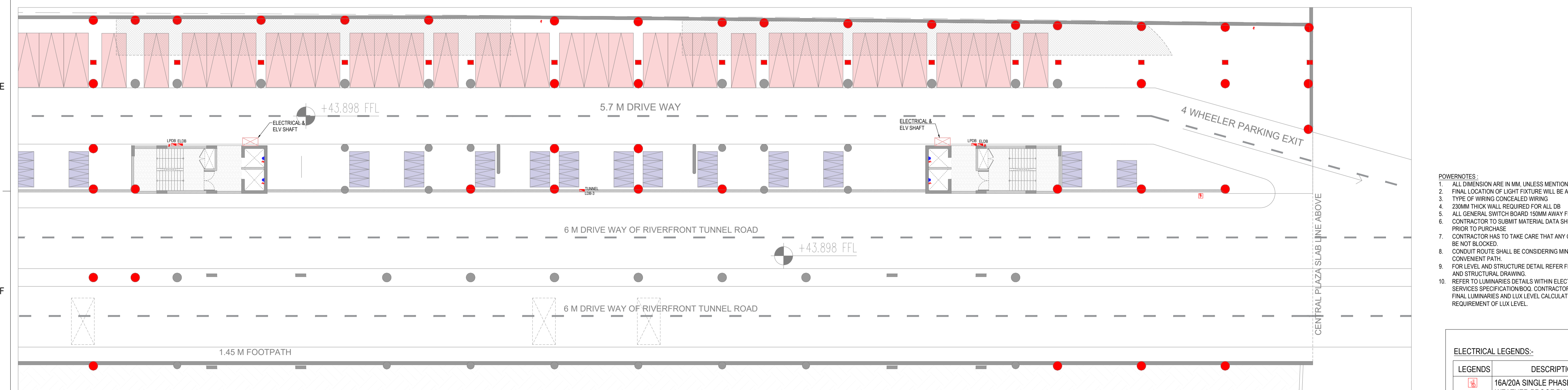

PART-03

General Notes

1. DRAWINGS ARE THE COPYRIGHT PROPERTY OF INI DESIGN STUDIO (Formerly Startec Consulting).
2. THESE DRAWINGS INDICATE IN GENERAL THE PROJECT IN TERMS OF BUILDING DESIGN CONCEPTS, THE DIMENSIONS OF THE BUILDINGS AND THE MAJOR BUILDING DESIGN ELEMENTS. AS INDICATED OR SPECIFIED, THE CONTRACTOR SHALL FINISH ALL ITEMS REQUIRED FOR THE PROPER EXECUTION AND COMPLETION OF THE PROJECT.
3. ALL DIMENSIONS ARE IN MILLIMETERS UNLESS OTHERWISE MENTIONED/SPECIFIED.
4. DRAWINGS IN NO CASE SHALL BE SCALED AND ONLY WRITTEN DIMENSIONS SHALL BE FOLLOWED. LARGE SCALE DETAILS SHALL TAKE PRECEDENCE OVER SMALL SCALE DRAWINGS.
5. PARTITIONS AND WALLS SHOWN CENTERED ON COLUMN CENTER OR FLUSH-FACED WITH STRUCTURAL COLUMN ARE NOT DIMENSIONED.
6. CONTRACTOR SHALL INFORM AND OBTAIN PERMISSION IN WRITING FROM THE INI BEFORE MAKING ANY DEVIATIONS FROM THE DRAWINGS.
7. ITEMS OF WORK REQUIRED ON ONE DRAWING OR IN ONE SECTION OF THE SPECIFICATIONS HAVE THE SAME FORCE AND EFFECT AS IF REQUIRED IN ALL DRAWINGS OR IN ALL SECTIONS OF THE SPECIFICATIONS.
8. PLINTH LEVELS TO BE DECIDED ON SITE WITH REFERENCE TO LEVELS ON THE SITE IN CONSULTATION WITH BUILDING DESIGN DRAWINGS.
9. FOR DOOR AND WINDOWS SCHEDULE REFER DRAWING NO.
10. FOR ROOF FINISH SCHEDULE REFER DRAWING NO.
11. RAIN WATER DRAIN PIPES OR SLEEVES THROUGH BEAMS AND CURBING TO BE INSTALLED WHILE CASTING AS PER THE POSITIONS SHOWN.
12. FOR DIMENSIONS, LOCATIONS AND DETAILS OF ALL STRUCTURAL MEMBERS REFER STRUCTURAL DRAWINGS.
13. DIMENSIONS ON ALL ELEVATIONS AND SECTIONS SHOWN ON BUILDING DESIGN DRAWINGS ARE SHOWN AS TOP OF UNFINISHED FLOOR LEVEL UNLESS OTHERWISE MENTIONED.
14. ALL DRAWINGS SHALL BE READ IN CONJUNCTION WITH ALL OTHER CONSULTANTS' DRAWINGS, TOGETHER WITH THE SPECIFICATIONS, DISCREPANCIES AND / OR AMBIGUITIES, IF ANY, SHALL BE BROUGHT TO THE NOTICE OF THE INI AND CLARIFICATIONS SHALL BE MADE PRIOR TO EXECUTION. SCPL'S DECISION IN THIS REGARD SHALL BE FINAL AND BINDING.
15. THE CONTRACTOR SHALL COORDINATE ALL MECHANICAL, FLOOR AND WALL SLEEVES AND SHAFTS IN CONCRETE SLABS AND WALLS WITH MECHANICAL, PLUMBING, FIRE PROTECTION, ELECTRICAL, STRUCTURAL AND BUILDING DESIGN DRAWINGS.
16. NOTES APPEARING ON VARIOUS DRAWINGS FOR DIFFERENT SYSTEMS AND MATERIAL SHEET SHALL BE REVIEWED AND NOTES ON ANY ONE DRAWING SHALL BE APPLIED TO RELATED DRAWINGS AND DETAILS.

THESE DRAWINGS ARE NOT CONSTRUCTION DRAWINGS AND THEY DO NOT PURPOSE TO DO SO. THEY ARE CONCEPTUAL DESIGN DRAWINGS FOR UNDERSTANDING OF THE BUILDING AND MODIFICATIONS ARE TO BE EXPECTED IN FINAL CONSTRUCTION DRAWINGS.

ADEQUACY CHECK-BY CONTRACTOR

Contractors are required to comprehensively review this drawing and report within 10 days to the architect with any of the following:

1. Missing information in the drawing.
2. Request for revision in construction details w.r.t ease of construction.
3. Request for clarifications regarding Tender / Non-tender items.

This check is to ensure that revisions in drawing are not sought during the construction process, thus ensuring timely completion of the project.

NO	Issued For Tender	30/01/2026	PJ
Rev	Purpose of Issue	Date	Author

TENDER DRAWING



Project: **SRFDCL_RIVERSIDE SAVOURIES**

Client: **Sabarmati Riverfront**
Reconnecting Ahmedabad to its River

Design Consultant: **INI DESIGN STUDIO** (Formerly Startec Consulting)
71/ 72, Starium, Corporate Road, Satellite, Ahmedabad-380015
Phone: +91 79 6612870 / 71/ 72 Starium, Corporate Road, Satellite, Ahmedabad-380015
E-mail: ini@inidesignstudio.com
Web: www.inidesignstudio.com

Parcel Name: _____

Drawing title: **POWERLAYOUT BASEMENT CEILING PLAN**

INI Project Number: **124200602**

Original Scale	Drawn	Checked	Authorised	Size
1:225	Date: 30/01/2026	Date: 30/01/2026	Date: 30/01/2026	Rev: R0

Drawing Number: **RS-E-301**

- POWERNOTES:**
1. ALL DIMENSION ARE IN MM, UNLESS MENTIONED
 2. FINAL LOCATION OF LIGHT FIXTURE WILL BE AS PER RCP.
 3. TYPE OF WIRING CONCEALED WIRING
 4. 230MM THICK WALL REQUIRED FOR ALL DB
 5. ALL GENERAL SWITCH BOARD 150MM AWAY FROM WALL EDGE
 6. CONTRACTOR TO SUBMIT MATERIAL DATA SHEET FOR APPROVAL PRIOR TO PURCHASE
 7. CONTRACTOR HAS TO TAKE CARE THAT ANY CONDUIT PATH SHALL BE NOT BLOCKED.
 8. CONDUIT ROUTE SHALL BE CONSIDERING MINIMUM BEND AND CONVENIENT PATH.
 9. FOR LEVEL AND STRUCTURE DETAIL REFER FINAL ARCHITECTURAL AND STRUCTURAL DRAWING.
 10. REFER TO LUMINARIES DETAILS WITHIN ELECTRICAL ENGINEERING SERVICES SPECIFICATION. CONTRACTOR TO SUBMIT DETAIL OF FINAL LUMINARIES AND LUX LEVEL CALCULATION WHICH MATCH REQUIREMENT OF LUX LEVEL.

ELECTRICAL LEGENDS:-

LEGENDS	DESCRIPTION
	16A/20A SINGLE PHASE IP66 INDUSTRIAL WEATHER PROOF PLUG POINT
	6/16A SWITCH SOCKET OUTLET

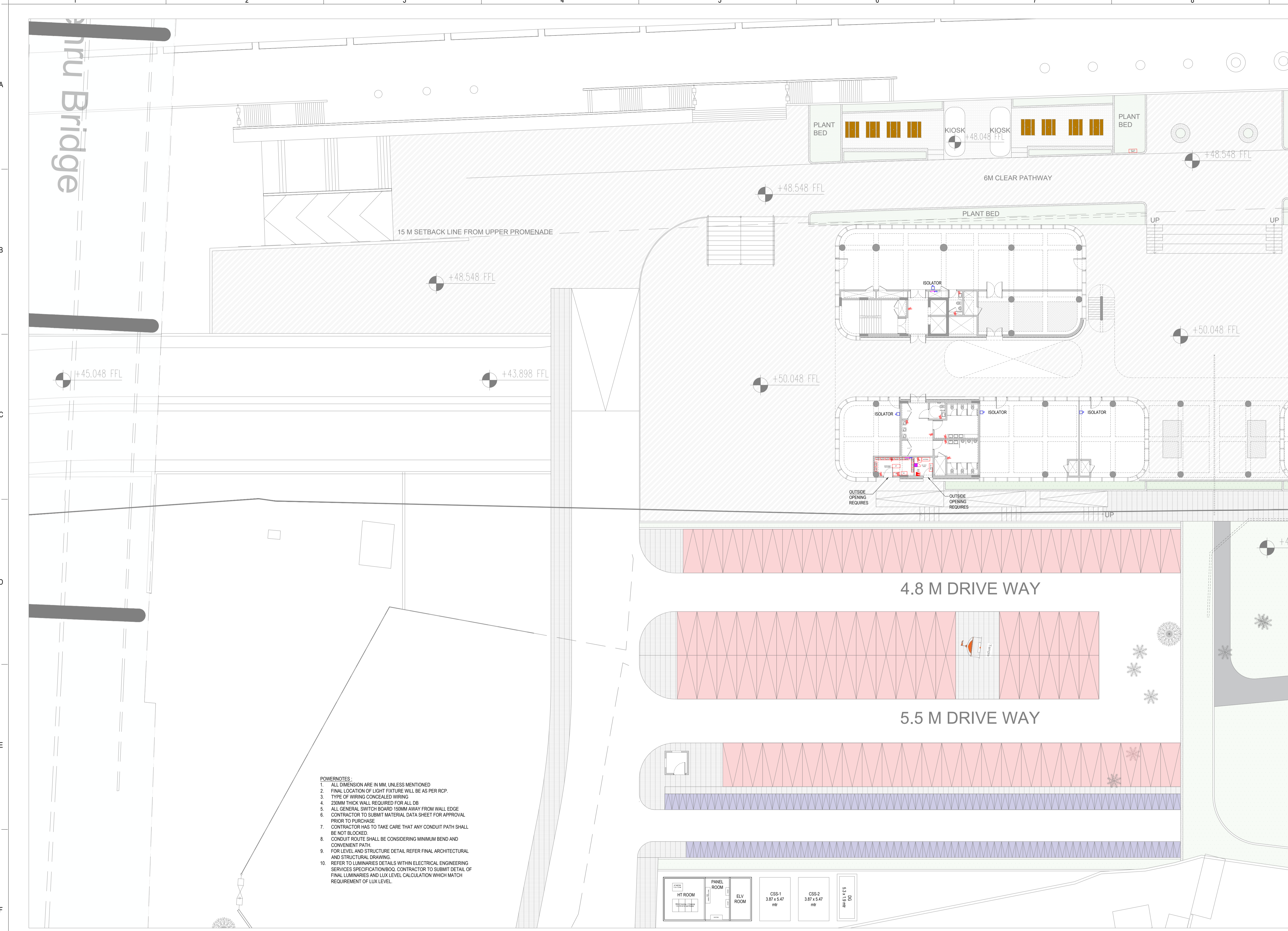

- POWERNOTES :**
1. ALL DIMENSION ARE IN MM, UNLESS MENTIONED
 2. FINAL LOCATION OF LIGHT FIXTURE WILL BE AS PER RCP.
 3. TYPE OF WIRING CONCEALED WIRING
 4. 20MM THICK WALL REQUIRED FOR ALL DB
 5. ALL GENERAL SWITCH BOARD 150MM AWAY FROM WALL EDGE
 6. CONTRACTOR TO SUBMIT MATERIAL DATA SHEET FOR APPROVAL PRIOR TO PURCHASE
 7. CONTRACTOR HAS TO TAKE CARE THAT ANY CONDUIT PATH SHALL BE NOT BLOCKED.
 8. CONDUIT ROUTE SHALL BE CONSIDERING MINIMUM BEND AND CONVENIENT PATH.
 9. FOR LEVEL AND STRUCTURE DETAIL REFER FINAL ARCHITECTURAL AND STRUCTURAL DRAWING
 10. REFER TO LUMINARIES DETAILS WITHIN ELECTRICAL ENGINEERING SERVICES SPECIFICATION/BOQ. CONTRACTOR TO SUBMIT DETAIL OF FINAL LUMINARIES AND LUX LEVEL CALCULATION WHICH MATCH REQUIREMENT OF LUX LEVEL.

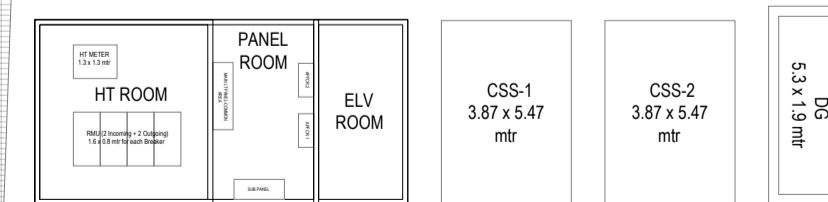

- General Notes**
1. DRAWINGS ARE THE COPYRIGHT PROPERTY OF INI DESIGN STUDIO (Formerly Startec Consulting)
 2. THESE DRAWINGS AND SPECIFICATIONS FOR THIS PROJECT ARE PROTECTED BY COPYRIGHT AND WILL NOT BE REPRODUCED, USED, OR DISTRIBUTED WITHOUT EXPRESS WRITTEN PERMISSION OF INI DESIGN STUDIO.
 3. THESE DRAWINGS INDICATE IN GENERAL, THE PROJECT IN TERMS OF BUILDING CONCEPTS, THE DIMENSIONS OF THE BUILDINGS AND THE MAJOR BUILDING DESIGN ELEMENTS. AS INDICATED OR SPECIFIED, THE CONTRACTOR SHALL FINISH ALL ITEMS REQUIRED FOR THE PROPER EXECUTION AND COMPLETION OF THE DECISIONS OF THE INI AS TO THE ITEMS OF WORK INCLUDED WITHIN THE DOCUMENT SHALL BE FINAL AND BINDING ON THE CONTRACTOR.
 4. ALL DIMENSIONS ARE IN MILLIMETERS UNLESS OTHERWISE MENTIONED / SPECIFIED.
 5. DRAWINGS IN NO CASE SHALL BE SCALED AND ONLY WRITTEN DIMENSIONS SHALL BE FOLLOWED. LARGE SCALE DETAILS SHALL TAKE PRECEDENCE OVER SMALL SCALE DRAWINGS.
 6. PARTITIONS AND WALLS SHOWN CENTERED ON COLUMN CENTER OR FLUSH-FACED WITH STRUCTURAL COLUMNS ARE NOT DIMENSIONED.
 7. CONTRACTOR SHALL INFORM AND OBTAIN PERMISSION IN WRITING FROM THE INI BEFORE MAKING ANY DEVIATIONS FROM THE DRAWINGS.
 8. ITEMS OF WORK REQUIRED ON ONE DRAWING OR IN ONE SECTION OF THE SPECIFICATIONS HAVE THE SAME FORCE AND EFFECT AS IF REQUIRED IN ALL DRAWINGS OR IN ALL SECTIONS OF THE SPECIFICATIONS.
 9. PLINTH LEVELS TO BE DECIDED ON SITE WITH REFERENCE TO LEVELS ON THE SITE IN CONSULTATION WITH BUILDING DESIGN DRAWINGS.
 10. FOR DOOR AND WINDOWS SCHEDULE REFER DRAWING NO. _____
 11. MAIN WATER DRAIN PIPES OR SLEEVES THROUGH BEAMS AND CURBING TO BE INSTALLED WHILE CASTING AS PER THE POSITIONS SHOWN.
 12. FOR DIMENSIONS, LOCATIONS AND DETAILS OF ALL STRUCTURAL MEMBERS REFER STRUCTURAL DRAWINGS.
 13. DIMENSIONS ON ALL ELEVATIONS AND SECTIONS SHOWN ON BUILDING DESIGN DRAWINGS ARE SHOWN AS TOP OF UNFINISHED FLOOR LEVEL UNLESS OTHERWISE MENTIONED.
 14. ALL DRAWINGS SHALL BE READ IN CONJUNCTION WITH ALL OTHER CONSULTANTS' DRAWINGS TOGETHER WITH THE SPECIFICATIONS. DISCREPANCIES AND / OR AMBIGUITIES, IF ANY, SHALL BE BROUGHT TO THE NOTICE OF THE INI AND CLARIFICATIONS SHALL BE MADE PRIOR TO EXECUTION. SCPL'S DECISION IN THIS REGARD SHALL BE FINAL AND BINDING.
 15. THE CONTRACTOR SHALL COORDINATE ALL MECHANICAL FLOOR AND WALL SLEEVES AND SHAKTS IN CONCRETE SLABS AND WALLS WITH MECHANICAL, PLUMBING, FIRE PROTECTION, ELECTRICAL, STRUCTURAL AND BUILDING DESIGN DRAWINGS.
 16. NOTES APPEARING ON VARIOUS DRAWINGS FOR DIFFERENT SYSTEMS AND MATERIAL SHEET SHALL BE REVIEWED AND NOTES ON ANY ONE DRAWING SHALL BE APPLIED TO RELATED DRAWINGS AND DETAILS.

THESE DRAWINGS ARE NOT CONSTRUCTION DRAWINGS AND THEY DO NOT PURPOSE TO DO SO. THEY ARE CONCEPTUAL DESIGN DRAWINGS FOR UNDERSTANDING OF THE BUILDING AND MODIFICATIONS ARE TO BE EXPECTED IN FINAL CONSTRUCTION DRAWINGS.

- ADEQUACY CHECK-BY CONTRACTOR**
- Contractors are required to comprehensively review this drawing and report within 15 days to the architect with any of the following:
1. Missing information in the drawings.
 2. Request for revision in construction details w.r.t ease of construction.
 3. Request for clarifications regarding Tender / Non-tender items.

This check is to ensure that revisions in drawing are not sought during the construction process, thus ensuring timely completion of the project.

NO	Issued For Tender	30/01/2026	PJ
Rev	Purpose of Issue	Date	Author

TENDER DRAWING

Key Plan

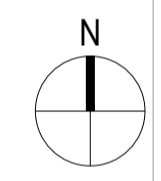

Project: **SRFDCL_RIVERSIDE SAVOURIES**

Client: **Sabarmati Riverfront**
Reconnecting Ahmedabad to its River

Design Consultant: **INI DESIGN STUDIO** (Formerly Startec Consulting)
71/ 72, Starlink, Corporate Road, Satellite, Ahmedabad-380015
Phone: +91 79 66128670 / 71/ 72 Starlink +91 79 66128673
E-mail: info@inidesignstudio.com
Web: www.inidesignstudio.com

Design: MPP Engineering, Interior, Landscape, Urban Design, P&C, Master Planning, Urban & Regional Planning, Visualization & Research

INI DESIGN STUDIO Ahmedabad | Mumbai | Pune | Kolkata

Drawing title: **POWER LAYOUT GROUND FLOOR (SITE) PLAN - PART-01**

INI Project Number: **124200602**

Original Scale	Drawn	Checked	Authorised	Size
1:225	GC	PC	PJ	

Drawing Number:	Rev
RS-E-302	R0

ELECTRICAL LEGENDS:-

LEGENDS	DESCRIPTION
	6A SWITCH SOCKET OUTLET
	6/16A SWITCH SOCKET OUTLET



General Notes

1. DRAWINGS ARE THE COPYRIGHT PROPERTY OF INI DESIGN STUDIO (Formerly Startec Consulting).
2. THE DRAWINGS AND SPECIFICATIONS FOR THIS PROJECT ARE PROTECTED BY COPYRIGHT AND WILL NOT BE REPRODUCED, USED, OR DISTRIBUTED WITHOUT EXPRESS WRITTEN PERMISSION OF INI DESIGN STUDIO.
3. THESE DRAWINGS INDICATE IN GENERAL THE PROJECT IN TERMS OF BUILDING DESIGN ELEMENTS. AS INDICATED OR SPECIFIED, THE CONTRACTOR SHALL FINISH ALL ITEMS REQUIRED FOR THE PROPER EXECUTION AND COMPLETION OF THE DECISIONS OF THE INI AS TO THE ITEMS OF WORK INCLUDED WITHIN THE DOCUMENT SHALL BE FINAL AND BINDING ON THE CONTRACTOR.
4. ALL DIMENSIONS ARE IN MILLIMETERS UNLESS OTHERWISE MENTIONED / SPECIFIED.
5. DRAWINGS IN NO CASE SHALL BE SCALED AND ONLY WRITTEN DIMENSIONS SHALL BE FOLLOWED. LARGE SCALE DETAILS SHALL TAKE PRECEDENCE OVER SMALL SCALE DRAWINGS.
6. PARTITIONS AND WALLS SHOWN CENTERED ON COLUMN CENTER OR FLUSH-FACED WITH STRUCTURAL COLUMNS ARE NOT DIMENSIONED.
7. CONTRACTOR SHALL INFORM AND OBTAIN PERMISSION IN WRITING FROM THE INI BEFORE MAKING ANY DEVIATIONS FROM THE DRAWINGS.
8. ITEMS OF WORK REQUIRED ON ONE DRAWING OR IN ONE SECTION OF THE SPECIFICATIONS HAVE THE SAME FORCE AND EFFECT AS IF REQUIRED IN ALL DRAWINGS OR IN ALL SECTIONS OF THE SPECIFICATIONS.
9. PLINTH LEVELS TO BE DECIDED ON SITE WITH REFERENCE TO LEVELS ON THE SITE IN CONSULTATION WITH BUILDING DESIGN DRAWINGS.
10. FOR DOOR AND WINDOWS SCHEDULE REFER DRAWING NO.
11. RAIN WATER DRAIN PIPES OR SLEEVES THROUGH BEAMS AND CURBING TO BE CASTED WHILE CASTING AS PER THE POSITIONS SHOWN.
12. FOR DIMENSIONS, LOCATIONS AND DETAILS OF ALL STRUCTURAL MEMBERS REFER STRUCTURAL DRAWINGS.
13. DIMENSIONS ON ALL ELEVATIONS AND SECTIONS SHOWN ON BUILDING DESIGN DRAWINGS ARE SHOWN AS TOP OF UNFINISHED FLOOR LEVEL UNLESS OTHERWISE MENTIONED.
14. ALL DRAWINGS SHALL BE READ IN CONJUNCTION WITH ALL OTHER CONSULTANTS' DRAWINGS TOGETHER WITH THE SPECIFICATIONS. DISCREPANCIES AND / OR AMBIGUITIES, IF ANY, SHALL BE BROUGHT TO THE NOTICE OF THE INI AND CLARIFICATIONS SHALL BE MADE PRIOR TO EXECUTION. SCPL'S DECISION IN THIS REGARD SHALL BE FINAL AND BINDING.
15. THE CONTRACTOR SHALL COORDINATE ALL MECHANICAL FLOOR AND WALL SLEEVES AND SHAKTS IN CONCRETE SLABS AND WALLS WITH MECHANICAL, PLUMBING, FIRE PROTECTION, ELECTRICAL, STRUCTURAL AND BUILDING DESIGN DRAWINGS.
16. NOTES APPEARING ON VARIOUS DRAWINGS FOR DIFFERENT SYSTEMS AND MATERIAL SHEET SHALL BE REVIEWED AND NOTES ON ANY ONE DRAWING SHALL BE APPLIED TO RELATED DRAWINGS AND DETAILS.

THESE DRAWINGS ARE NOT CONSTRUCTION DRAWINGS AND THEY DO NOT PURPOSE TO DO SO. THEY ARE CONCEPTUAL DESIGN DRAWINGS FOR UNDERSTANDING OF THE BUILDING AND MODIFICATIONS ARE TO BE EXPECTED IN FINAL CONSTRUCTION DRAWINGS.

ADEQUACY CHECK BY CONTRACTOR

Contractors are required to comprehensively review this drawing and report within 15 days to the architect with any of the following:

1. Missing information in the drawings.
2. Request for revision in construction details = 1 case of construction.
3. Request for clarifications regarding Tender / Non-tender items.

This check is to ensure that revisions in drawing are not sought during the construction process, thus ensuring timely completion of the project.

NO	Issued For Tender	30/01/2026	PJ
Rev	Purpose of Issue	Date	Author

TENDER DRAWING

Key Plan

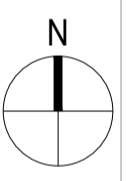

Project:
SRFDCL_RIVERSIDE SAVOURIES

Client:
Sabarmati Riverfront
Reconnecting Ahmedabad to its River

Design Consultant:
INI DESIGN STUDIO (Formerly Startec Consulting)
71/72, Starlink, Corporate Road, Satellite, Ahmedabad-380015
Phone: +91 79 66128870 / 71/72 Starlink +91 79 66128873
E-mail: ini@inidesignstudio.com
Web: www.inidesignstudio.com

Parcel Name:
Drawing title:
POWER LAYOUT
GROUND FLOOR (SITE) PLAN - PART-02

INI Project Number:
124200602

Original Scale	Drawn	Checked	Authorised	Size
1:225	Date: 30/01/2026	Date: 30/01/2026	Date: 30/01/2026	Rev: R0

Drawing Number:
RS-E-302A

- POWERNOTES:**
1. ALL DIMENSION ARE IN MM, UNLESS MENTIONED
 2. FINAL LOCATION OF LIGHT FIXTURE WILL BE AS PER RCP.
 3. TYPE OF WIRING CONCEALED WIRING
 4. 230MM THICK WALL REQUIRED FOR ALL DB
 5. ALL GENERAL SWITCH BOARD 150MM AWAY FROM WALL EDGE
 6. CONTRACTOR TO SUBMIT MATERIAL DATA SHEET FOR APPROVAL
 7. PRIOR TO PURCHASE CONTRACTOR HAS TO TAKE CARE THAT ANY CONDUIT PATH SHALL BE NOT BLOCKED
 8. CONDUIT ROUTE SHALL BE CONSIDERING MINIMUM BEND AND CONVENIENT PATH.
 9. FOR LEVEL AND STRUCTURE DETAIL REFER FINAL ARCHITECTURAL AND STRUCTURAL DRAWING.
 10. REFER TO LUMINARIES DETAILS WITHIN ELECTRICAL ENGINEERING SERVICES SPECIFICATION/BQ. CONTRACTOR TO SUBMIT DETAIL OF FINAL LUMINARIES AND LUX LEVEL CALCULATION WHICH MATCH REQUIREMENT OF LUX LEVEL.

ELECTRICAL LEGENDS:-

LEGENDS	DESCRIPTION
	6A SWITCH SOCKET OUTLET
	6/16A SWITCH SOCKET OUTLET

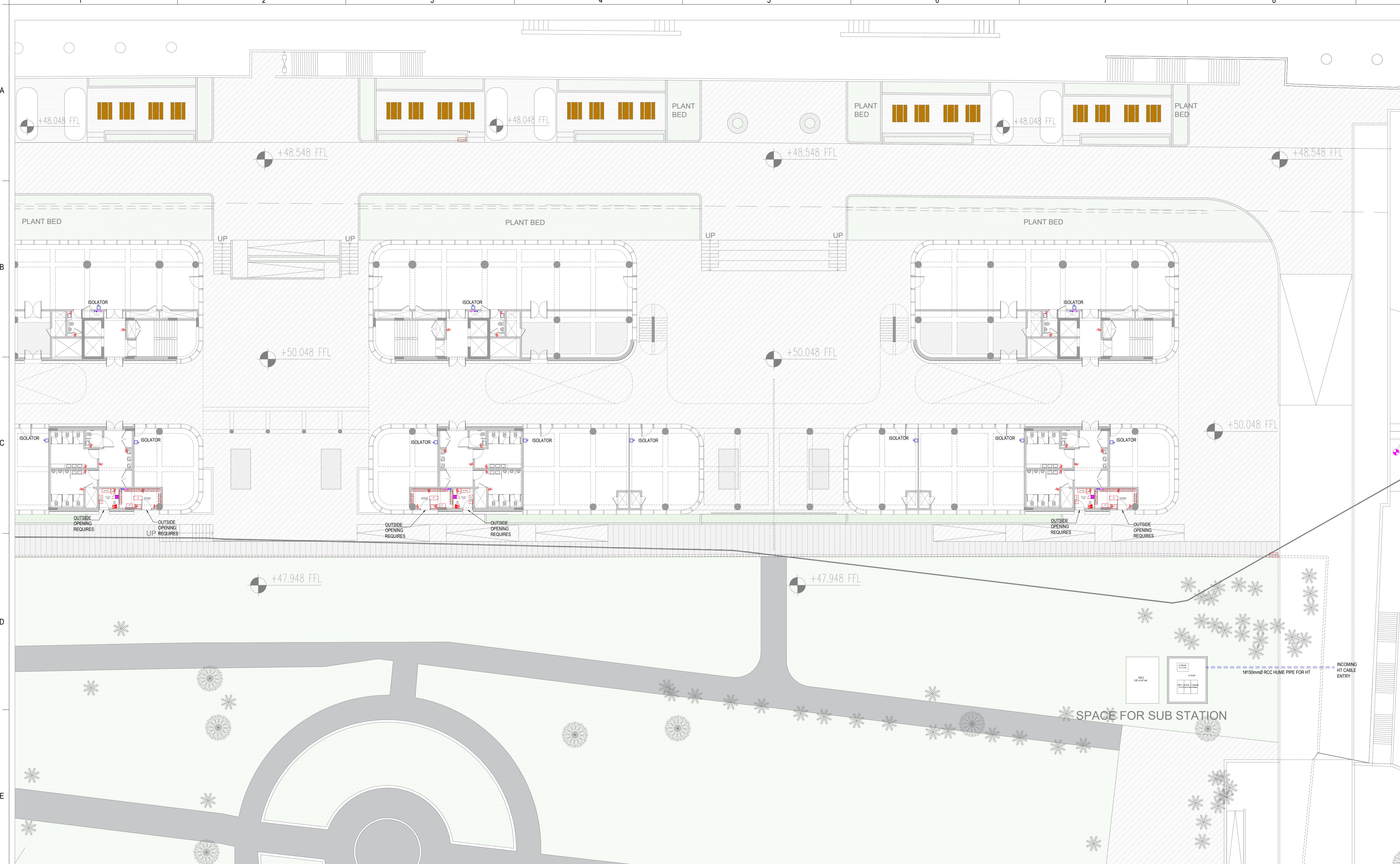

General Notes

1. DRAWINGS ARE THE COPYRIGHT PROPERTY OF INI DESIGN STUDIO (Formerly Startec Consulting).
2. THE DRAWINGS AND SPECIFICATIONS FOR THIS PROJECT ARE PROTECTED BY COPYRIGHT AND WILL NOT BE REPRODUCED, USED, OR DISTRIBUTED WITHOUT EXPRESS WRITTEN PERMISSION OF INI DESIGN STUDIO.
3. THESE DRAWINGS INDICATE IN GENERAL THE PROJECT IN TERMS OF BUILDING DESIGN CONCEPTS THE DIMENSIONS OF THE BUILDINGS AND THE MAJOR BUILDING DESIGN ELEMENTS. AS INDICATED OR SPECIFIED, THE CONTRACTOR SHALL FINISH ALL ITEMS REQUIRED FOR THE PROPER EXECUTION AND COMPLETION OF THE DECISIONS OF THE INAS TO THE ITEMS OF WORK INCLUDED WITHIN THE DOCUMENT SHALL BE FINAL AND BINDING ON THE CONTRACTOR.
4. ALL DIMENSIONS ARE IN MILLIMETERS UNLESS OTHERWISE MENTIONED/SPECIFIED. DRAWINGS IN NO CASE SHALL BE SCALED AND ONLY WRITTEN DIMENSIONS SHALL BE FOLLOWED. LARGE SCALE DETAILS SHALL TAKE PRECEDENCE OVER SMALL SCALE DRAWINGS.
5. PARTITIONS AND WALLS SHOWN CENTERED ON COLUMN CENTER OR FLUSH-FACED WITH STRUCTURAL COLUMNS ARE NOT DIMENSIONED.
6. CONTRACTOR SHALL INFORM AND OBTAIN PERMISSION IN WRITING FROM THE INI BEFORE MAKING ANY DEVIATIONS FROM THE DRAWINGS.
7. ITEMS OF WORK REQUIRED ON ONE DRAWING OR IN ONE SECTION OF THE SPECIFICATIONS HAVE THE SAME FORCE AND EFFECT AS IF REQUIRED IN ALL DRAWINGS OR IN ALL SECTIONS OF THE SPECIFICATIONS.
8. PLINTH LEVELS TO BE DECIDED ON SITE WITH REFERENCE TO LEVELS ON THE SITE IN CONSULTATION WITH BUILDING DESIGN DRAWINGS.
9. FOR DOOR AND WINDOWS SCHEDULE REFER DRAWING NO.
10. FOR FLOOR FINISH SCHEDULE REFER DRAWING NO.
11. RAIN WATER DRAIN PIPES OR SLEEVES THROUGH BEAMS AND CURBING TO BE INSTALLED WHILE CASTING AS PER THE POSITIONS SHOWN.
12. FOR DIMENSIONS, LOCATIONS AND DETAILS OF ALL STRUCTURAL MEMBERS REFER STRUCTURAL DRAWINGS.
13. DIMENSIONS ON ALL ELEVATIONS AND SECTIONS SHOWN ON BUILDING DESIGN DRAWINGS ARE SHOWN AS TOP OF UNFINISHED FLOOR LEVEL UNLESS OTHERWISE MENTIONED.
14. ALL DRAWINGS SHALL BE READ IN CONJUNCTION WITH ALL OTHER CONSULTANTS' DRAWINGS TOGETHER WITH THE SPECIFICATIONS. DISCREPANCIES AND / OR AMBIGUITIES, IF ANY, SHALL BE BROUGHT TO THE NOTICE OF THE INI AND CLARIFICATIONS SHALL BE MADE PRIOR TO EXECUTION. SCPL'S DECISION IN THIS REGARD SHALL BE FINAL AND BINDING.
15. THE CONTRACTOR SHALL COORDINATE ALL MECHANICAL FLOOR AND WALL SLEEVES AND SHAKES IN CONCRETE SLABS AND WALLS WITH MECHANICAL, PLUMBING, FIRE PROTECTION, ELECTRICAL, STRUCTURAL AND BUILDING DESIGN DRAWINGS.
16. NOTES APPEARING ON VARIOUS DRAWINGS FOR DIFFERENT SYSTEMS AND MATERIAL SHEET SHALL BE REVIEWED AND NOTES ON ANY ONE DRAWING SHALL BE APPLIED TO RELATED DRAWINGS AND DETAILS.

THESE DRAWINGS ARE NOT CONSTRUCTION DRAWINGS AND THEY DO NOT PURPOSE TO DO SO. THEY ARE CONCEPTUAL DESIGN DRAWINGS FOR UNDERSTANDING OF THE BUILDING AND MODIFICATIONS ARE TO BE EXPECTED IN FINAL CONSTRUCTION DRAWINGS.

ADEQUACY CHECK-BY CONTRACTOR

Contractors are required to comprehensively review this drawing and revert within 10 days to the architect with any of the following:

1. Missing information in the drawings.
2. Request for revision in construction details w.r.t ease of construction.
3. Request for clarifications regarding Tender / Non-tender items.

This check is to ensure that revisions in drawing are not sought during the construction process, thus ensuring timely completion of the project.

NO	Issued For Tender	30/01/2026	PJ
Rev	Purpose of Issue	Date	Authorised

TENDER DRAWING



Project: **SRFDCL_RIVERSIDE SAVOURIES**

Client: **Sabarmati Riverfront**
Reconnecting Ahmedabad to its River

Design Consultant: **INI DESIGN STUDIO** (Formerly Startec Consulting)

71/ 72, Starium, Corporate Road, Satellite, Ahmedabad-380015
Phone: +91 79 6612870 / 71 72 72 Fax: +91 79 6612873
E-mail: info@inidesignstudio.com
Web: www.inidesignstudio.com

Design: MPE Engineering, Inevator, Lanticox, Urban Design, PNC, Master Planning, Urban & Regional Planning, Visualization & Research

INI DESIGN STUDIO Ahmedabad | Mumbai | Pune | Kolkata

POWERNOTES:

1. ALL DIMENSION ARE IN MM, UNLESS MENTIONED
2. FINAL LOCATION OF LIGHT FIXTURE WILL BE AS PER RCP.
3. TYPE OF WIRING CONCEALED WIRING
4. 23MM THICK WALL REQUIRED FOR ALL DB
5. ALL GENERAL SWITCH BOARD 150MM AWAY FROM WALL EDGE
6. CONTRACTOR TO SUBMIT MATERIAL DATA SHEET FOR APPROVAL PRIOR TO PURCHASE
7. CONTRACTOR HAS TO TAKE CARE THAT ANY CONDUIT PATH SHALL BE NOT BLOCKED
8. CONDUIT ROUTE SHALL BE CONSIDERING MINIMUM BEND AND CONVENIENT PATH.
9. FOR LEVEL AND STRUCTURE DETAIL REFER FINAL ARCHITECTURAL AND STRUCTURAL DRAWING.
10. REFER TO LUMINARIES DETAILS WITHIN ELECTRICAL ENGINEERING SERVICES SPECIFICATION/BOQ. CONTRACTOR TO SUBMIT DETAIL OF FINAL LUMINARIES AND LUX LEVEL CALCULATION WHICH MATCH REQUIREMENT OF LUX LEVEL.

ELECTRICAL LEGENDS:-

LEGENDS	DESCRIPTION
	6A SWITCH SOCKET OUTLET
	6/16A SWITCH SOCKET OUTLET

Drawing title: **POWER LAYOUT**
GROUND FLOOR (SITE) PLAN - PART-03

INI Project Number: **124200602**

Original Scale	Drawn	Checked	Authorised	Size
1:25	Date: 30/01/2026	Date: 30/01/2026	Date: 30/01/2026	Rev: R0

Drawing Number: **RS-E-302B**

30 / 01 / 2026 - 4:48:09 PM

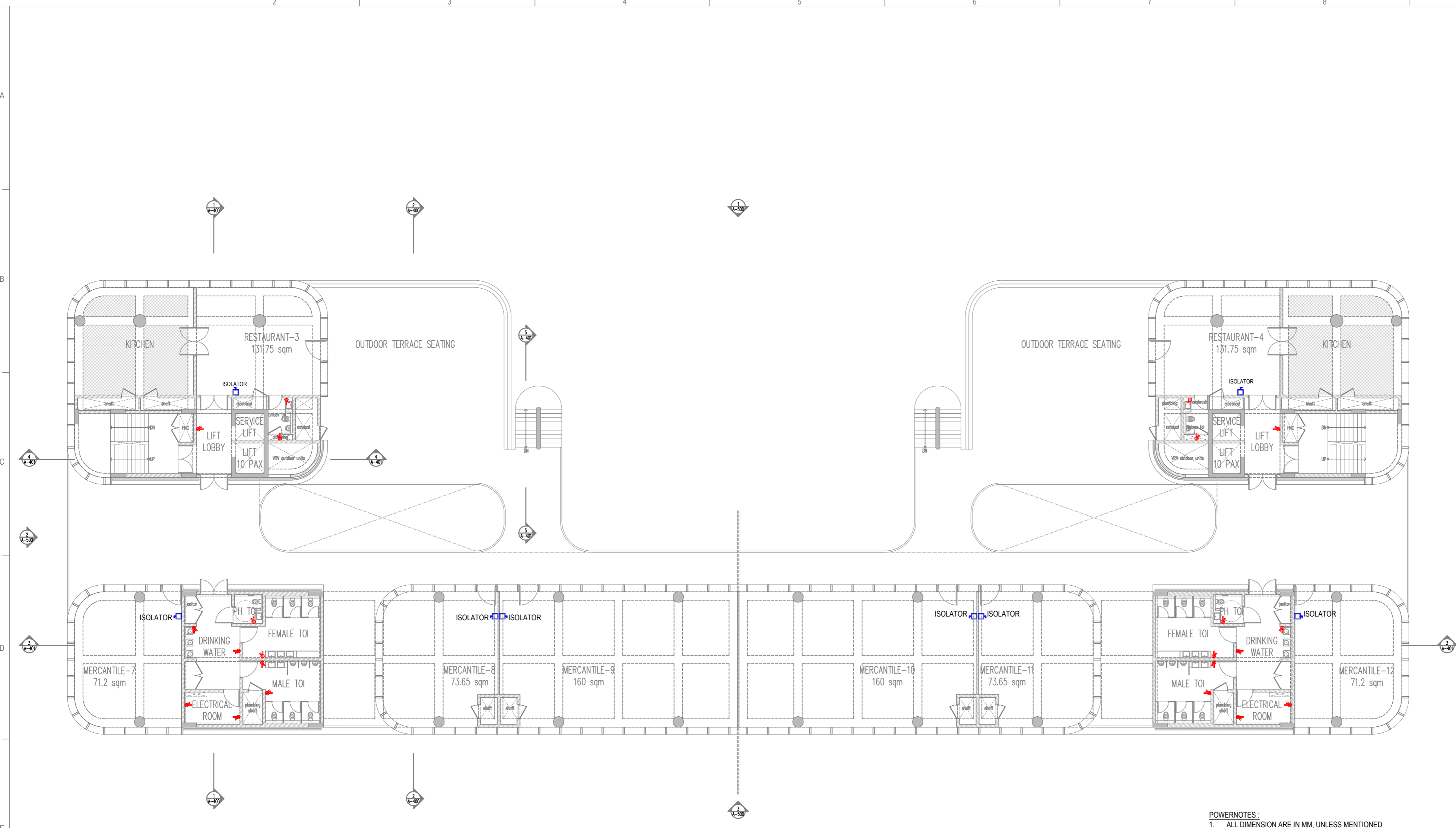

FIRST FLOOR PLAN

- General Notes
1. DRAWINGS ARE THE COPYRIGHT PROPERTY OF INI DESIGN STUDIO. THE DRAWINGS AND SPECIFICATIONS FOR THIS PROJECT ARE PROTECTED BY COPYRIGHT AND SHALL NOT BE REPRODUCED, USED, OR DISTRIBUTED WITHOUT EXPRESS WRITTEN PERMISSION OF INI DESIGN STUDIO.
 2. THESE DRAWINGS INDICATE IN GENERAL THE PROJECT IN TERMS OF BUILDING DESIGN CONCEPTS, THE DIMENSIONS OF THE BUILDINGS AND THE MAJOR BUILDING DESIGN ELEMENTS, AS INDICATED OR SPECIFIED, THE CONTRACTOR SHALL FINISH ALL ITEMS REQUIRED FOR THE PROPER EXECUTION AND COMPLETION OF THE WORKS. DECISIONS OF THE INI AS TO THE ITEMS OF WORK INCLUDED WITHIN THE DOCUMENT SHALL BE FINAL AND BINDING ON THE CONTRACTOR.
 3. ALL DIMENSIONS ARE IN MILLIMETERS, UNLESS OTHERWISE MENTIONED SPECIFIED.
 4. DRAWINGS IN NO CASE SHALL BE SCALED AND ONLY WRITTEN DIMENSIONS SHALL BE FOLLOWED. LARGE SCALE DETAILS SHALL TAKE PRECEDENCE OVER SMALL SCALE DRAWINGS.
 5. PARTITIONS AND WALLS SHOWN CENTERED ON COLUMN CENTER OR FLUSH-FACED WITH STRUCTURAL COLUMNS ARE NOT DIMENSIONED.
 6. CONTRACTOR SHALL INFORM AND OBTAIN PERMISSION IN WRITING FROM THE INI BEFORE MAKING ANY DEVIATIONS FROM THE DRAWINGS.
 7. ITEMS OF WORK REQUIRED ON ONE DRAWING OR IN ONE SECTION OF THE SPECIFICATIONS HAVE THE SAME FORCE AND EFFECT AS IF REQUIRED IN ALL DRAWINGS, OR IN ALL SECTIONS OF THE SPECIFICATIONS.
 8. PLINTH LEVELS TO BE DECIDED ON SITE WITH REFERENCE TO LEVELS ON THE SITE CONSULTATION WITH BUILDING DESIGN DRAWINGS.
 9. FOR DOOR AND WINDOW SCHEDULE REFER DRAWING NO. _____
 10. FOR ROOM FINISH SCHEDULE REFER DRAWING NO. _____
 11. RAIN WATER DRAIN PIPES OR SLEEVES THROUGH BEAMS AND CURBING TO BE INSTALLED IN PLACE AS PER THE POSITIONS SHOWN.
 12. FOR DIMENSIONS, LOCATIONS AND DETAILS OF ALL STRUCTURAL MEMBERS REFER STRUCTURAL DRAWINGS.
 13. DIMENSIONS ON ALL ELEVATIONS AND SECTIONS SHOWN ON BUILDING DESIGN DRAWINGS ARE SHOWN AS TOP OF UNFINISHED FLOOR LEVEL UNLESS OTHERWISE MENTIONED.
 14. ALL DRAWINGS SHALL BE READ IN CONJUNCTION WITH ALL OTHER CONSULTANTS' DRAWINGS, TOGETHER WITH THE SPECIFICATIONS, DISCREPANCIES AND/OR AMBIGUITIES, IF ANY, SHALL BE BROUGHT TO THE NOTICE OF THE INI AND CLARIFICATIONS SHALL BE MADE PRIOR TO EXECUTION. SOCI'S DECISION IN THIS REGARD SHALL BE FINAL AND BINDING.
 15. THE CONTRACTOR SHALL COORDINATE ALL MECHANICAL, ELECTRICAL, PLUMBING, FIRE PROTECTION, ELECTRICAL STRUCTURAL AND BUILDING DESIGN DRAWINGS.
 16. NOTES APPEARING ON VARIOUS DRAWINGS FOR DIFFERENT SYSTEMS AND MATERIAL SHEET SHALL BE REVIEWED AND NOTES ON ANY ONE DRAWING SHALL BE APPLIED TO RELATED DRAWINGS AND DETAILS.

Legend

RD	Issued For Tender	30/01/2026	PJ
Rev	Purpose of Issue	Date	Authorized

TENDER DRAWING PACKAGE

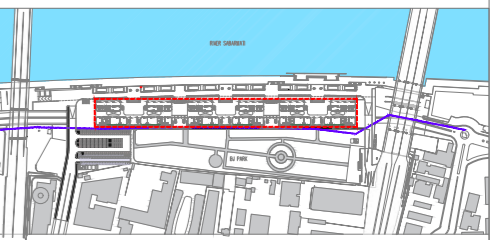

Key Plan

Project: SRFDCL_RIVERSIDE SAVOURIES



Design Consultant: INI DESIGN STUDIO (formerly Startek Consulting)
 71/72, Bhikun, Corporate Road, Satellite, Ahmedabad-380015
 Phone: +91 79 66128870 / 717 72 Fax: +91 79 66128873
 Email: info@inidesignstudio.com
 Website: www.inidesignstudio.com
 Design: MEP Engineering, Interiors, Landscape, Urban Design, PWD, Interior Planning, Smart & Regional Planning, Visualization & Animation
 INI DESIGN STUDIO Ahmedabad | Mumbai | Pune | Kolkata

INI Project no: 124200602

Parcel Name:

Building Name: BUILDING TYPE - A & B

Drawing title: FIRST FLOOR PLAN (TYPICAL BLOCK) POWER LAYOUT

Original Scale	Drawn	Checked	Authorised	Size
1:200	GC	PS	NS	A2
DWG	Date	Date	Date	Rev.
	30-01-2026	30-01-2026	30-01-2026	

RS-E-304 30 / 01 / 2026 - 4:48:17 PM

- POWERNOTES:
1. ALL DIMENSION ARE IN MM, UNLESS MENTIONED
 2. FINAL LOCATION OF LIGHT FIXTURE WILL BE AS PER RCP.
 3. TYPE OF WIRING CONCEALED WIRING
 4. 230MM THICK WALL REQUIRED FOR ALL DB
 5. ALL GENERAL SWITCH BOARD 150MM AWAY FROM WALL EDGE
 6. CONTRACTOR TO SUBMIT MATERIAL DATA SHEET FOR APPROVAL PRIOR TO PURCHASE
 7. CONTRACTOR HAS TO TAKE CARE THAT ANY CONDUIT PATH SHALL BE NOT BLOCKED.
 8. CONDUIT ROUTE SHALL BE CONSIDERING MINIMUM BEND AND CONVENIENT PATH.
 9. FOR LEVEL AND STRUCTURE DETAIL REFER FINAL ARCHITECTURAL AND STRUCTURAL DRAWING.
 10. REFER TO LUMINARIES DETAILS WITHIN ELECTRICAL ENGINEERING SERVICES SPECIFICATION/BOQ. CONTRACTOR TO SUBMIT DETAIL OF FINAL LUMINARIES AND LUX LEVEL CALCULATION WHICH MATCH REQUIREMENT OF LUX LEVEL.

ELECTRICAL LEGENDS:-

LEGENDS	DESCRIPTION
	6A SWITCH SOCKET OUTLET
	6/16A SWITCH SOCKET OUTLET

U:\124200602_SRFDCI_Riverside7_CADD\Bases - Electrical\DWG\Tender.dwg/Revised_30.01.2026\30_RS_POWER_TENDER.dwg, Fri, 30 Jan 2026, 11:12:42 AM

